

**Lewis River Hydroelectric Projects
Terrestrial Coordination Committee (TCC)
Meeting Agenda**

Date & Time: **Wednesday, November 14, 2018
9:00 a.m. – 12:00 p.m.**

Place: **Merwin Hydro Control Center
105 Merwin Village Court
Ariel, WA 98603**

Contacts: **Kendel Emmerson (503) 813-6040; cell 503-703-7734**

Time	Discussion Item
9:00 a.m.	Welcome <ul style="list-style-type: none">➤ Review Agenda & 10/10/18 Meeting Notes➤ Review and Accept Agenda & 10/10/18 Meeting Notes
9:15 a.m.	Eagle Island Project Report - WDFW
9:30 a.m.	Land Acquisition Update
10:00 a.m.	Break
10:15 a.m.	Devil's Backbone Update; budget and 2019 planning
10:45 a.m.	Forestry Plan Review Memo; Review
11:15 a.m.	Commercial Thin and Northern Goshawk Survey Decision Matrix
11:30 a.m.	Study/Work Product Updates <ul style="list-style-type: none">➤ Shrub exclosures➤ Public access issues Studebaker (MU 2) and MU 17
11:45 a.m.	Next Meeting's Agenda Note: all meeting notes and the meeting schedule can be located at: http://www.pacificorp.com/es/hydro.html
12:00 p.m.	Adjourn

**PLEASE BRING YOUR LUNCH IN THE EVENT
THE MEETING EXTENDS BEYOND NOON**

Join by Phone

+1 (503) 813-5252 [Portland, Ore.]

+1 (855) 499-5252 [Toll Free]

Conference ID: 5847894

FINAL Meeting Notes
Lewis River License Implementation
Terrestrial Coordination Committee (TCC) Meeting
November 14, 2018
Merwin Hydro Control Center

TCC Representatives Present: (10)

Kendel Emmerson, PacifiCorp
 Summer Peterman, PacifiCorp
 Kim McCune, PacifiCorp
 Peggy Miller, WDFW
 Amanda Froberg, Cowlitz PUD
 Erik White, Cowlitz Indian Tribe
 Nathan Reynolds, Cowlitz Indian Tribe
 Adam Cole, WA Recreation and Conservation Office (via conference)
 Ray Crosswell, RMEF
 Bill Richardson, RMEF

Calendar:

December 12, 2018	TCC Meeting	CANCELLED
January 9, 2019	TCC Meeting	Merwin HCC

Assignments from November 14, 2018	Status
McCune: Email Eagle Island Upland Restoration Project Progress Report to TCC.	Complete – 11/14/18
Froberg: Email DNR and request clarification on conversion designation of Devil’s Backbone and request “alternate plan” designation as more accurate (Attachment D).	Complete 11/16/18

Assignments from October 12, 2018	Status
Emmerson: Create high-country model of big elk use areas and a 10-15 year plan for silviculture management for TCC review.	Complete

Parking Lot Items	Status
WDFW: In regards to 10.3.3, Matching Funds Eagle Island Project the TCC would like a 1-2-page progress report of project status with photos after the grant term expires (12-31-2017).	Complete – 11/14/18
Emmerson/McCune: Contact PacifiCorp’s properties department to discuss further TNC detail and report to the TCC at the next meeting.	In progress

Kendel Emmerson (PacifiCorp) called the meeting to order at 9:07am. Emmerson reviewed the agenda and asked the TCC if there were any changes/additions. No additions were requested.

The TCC reviewed the October 10, 2018 meeting notes and the meeting notes were approved without change at 9:10am.

Public Comment Opportunity:

None

Eagle Island Upland Restoration Project Progress Report – WDFW

Please see [Attachment A](#) for complete progress report, provided by Daren Hauswald (WDFW).

Devil's Backbone Update; Budget and 2019 Planning

Amanda Froberg (Cowlitz PUD) provided a very thorough review of the location of the Devil's Backbone elk forage plot treatment prescription (5.8 acres), project costs, revenue and seed recommendations and 2019 budget ([Attachment B](#)).

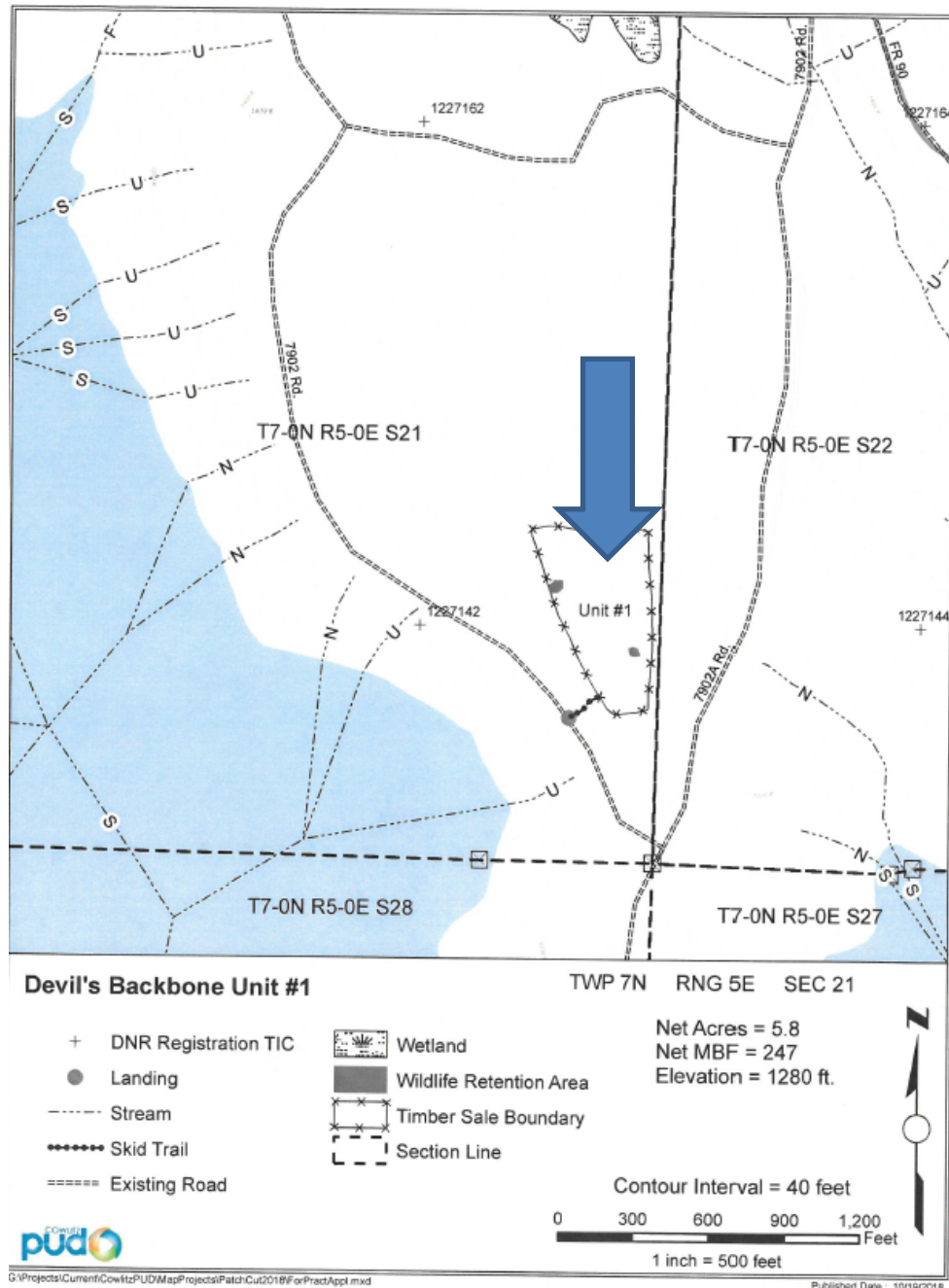

Considerable discussion took place about DNR requiring a forestry conversion fee of \$1,400, however, the TCC questions if this requirement is appropriate in this case. The TCC wishes to pursue an “alternate plan” based on the argument that the meadow creation is making the resource value better for people of Washington and wildlife. The Utilities will discuss this further off line and the PUD will speak with PacifiCorp’s forester and report to the TCC.

Also discussed was the RMEF grant monies that the PUD will apply for by December 1, 2018 and the request of 10.3.3 matching funds (\$13,725) from PacifiCorp assuming the PUD is awarded the RMEF grant monies.

The TCC requested the PUD absorb the logging, stumps and grubbing costs and to resubmit the budget to the TCC for its review and request a quick turnaround for approval.

Break 10:10am

Reconvene 10:20am

Forestry Plan Review Memo; Review

Emmerson informed the TCC attendees that the comment period was formally extended to November 30, 2018 for the *Lewis River Wildlife Habitat Management Plan (WHMP) Lands Timber Harvest and Silviculture Planning*, October 2, 2018. In addition, Emmerson explained that changes have already been made since the October meeting include the following:

- Language was added to explain that this memo does not change the WHMP, that it is only providing schedules for reforestation, silviculture and harvest.
- The timber harvest area (THA) categorized as meeting WHMP standards (THA-Habitat or THA-H) were changed to THA-Flat (THA-F). The THA that were categorized as forestry (THA-F) were changed to THA-STEPP (THA-S).
- Language was added to emphasize that clearcut harvest are selected to meeting cover:forage standards and the 60-year is not to be considered a harvest rotation.
- Language was added that some THA are considered beyond silviculture management and may be left to grow until they may be harvested and then apply WHMP management standards.

The TCC reviewed PacifiCorp’s draft memorandum and had clarifying questions regarding, but not limited to the following:

- The TCC requested that HEP and other models be reviewed to provide preferred percent cover per THA for the PCT Criteria and methods.
- Need to add language that this is adaptive management and criteria in the memo can be revised as needed to meet management objectives.
- Adding the following text, Evaluate percentage of commercial thinning with percentage of crown ratio to best accomplish WHMP goals
- Possibly add pictures in memorandum with explanation & rationale

Emmerson requested all additional comments/edits be sent to her attention via email.

Peggy Miller (WDFW) will email her edited version to the TCC attendees at today's meeting this week. Emmerson will then send a revised draft to the TCC by December 7, 2018 for another 30-day review and comment period.

Commercial thinning and Northern Goshawk Survey Decision Matrix

Criteria for Determining Type of Northern Goshawk Survey required prior to Commercial Thinning a Timber Harvest Area, November 14, 2018 ([Attachment C](#)). A model was created using past clear cut timber harvest area that will be commercially thinned in the future using the Northern Goshawk Survey Decision Matrix from the December 9, 2015 memo. This separated every clearcut harvest area into 11 survey category that have different survey types (Broadcast Acoustical, Intensive survey, No Survey, Habitat Analysis).

Emmerson provided a cursory review of the model that was based on the following criteria:

- Size of Timber Harvest Area (THA)
- THA potential within the Nest Area Cluster (NAC)
- Post-fledgling family area (PFA)
- Vegetation Cover Type
- Proximity to Old-growth and Mature timber

Once this model receives TCC approval and the Forestry Plan Memo is finalized, the associated Survey Category will added to the forestry plan spreadsheet.

Please review and send comments to Kendel Emmerson by December 9, 2015

Grass Legume Seed Plots (3,000' level)

The following two pictures show the grass legume seed plots placed in MU 36. There are two 20x20 plots. Half of each plot is covered to prevent germination while the other side was seeded this fall (late Sept) with a seed mix. Next spring the covered area will be seeded with the same mix to compare seeding times.



Unit 36 –GLSP #1 20' x 20' Enclosure



Unit 36 – GLSP #2 note the evidence of seed growth difference from fall seeding

In addition, two shrub exclosures were completed in MU 34 and 36. The exclosure in MU 36 the contractor had constructed an exclosure around the entire shrub area instead of just the 40x40 monitoring area. Within the exclosure a 40 x 40, area was delineated for monitoring.



Unit 34 Shrubland - (40 x 40' exclosure)



Unit 36 - (approx. 160' x 80' with a 40 x 40 section for the enclosure)

The MU 36 has dogwood, two kinds of huckleberry, vine maple and much more diversity than the MU 34 enclosure.

Public Access/Encroachment issues; Management Units 2 and 17

Emmerson expressed to the TCC attendees the growing concern and problems PacifiCorp is experiencing regarding public access/encroachment on PacifiCorp private lands such as large dumpsites of trash, ATV use when motorized vehicles are not allowed, cutting trails to the reservoir and vegetation and timber removal. PacifiCorp will be signing specific areas of its property with Wildlife Habitat Management Lands signs where public access issues are most obvious. Property owners along PacifiCorp property lines in MU 17 were sent a cease and desist letter regarding vegetation removal, cutting trails, etc.

Land Acquisition Update (CONFIDENTIAL)

Bill Richardson (RMEF) informed the TCC attendees that the appraisal and evaluations for the subject property were received today. The next meeting with the landowner will be December 2018.

Additional detail around this topic is considered confidential and proprietary and not for public viewing.

Other (CONFIDENTIAL)

TNC – Emmerson informed the TCC attendees that TNC wants to sell certain property to include a conservation easement. Discussion took place regarding entering into a conservation easement in perpetuity with PacifiCorp to include WHMP restrictions that survive beyond the life of the current 50 yr. license. WDFW could possibly hold the conservation easement and manage the resource through the TCC. PacifiCorp will continue conversations with TNC and TCC.

Agenda items for January 9, 2019

- Review November 14, 2018 Meeting Notes
- 2018 Terrestrial Funds Year-end Accounting
- Land Acquisition Update (Confidential)
- TNC Update (Confidential)
- Forestry Plan Review Memo; Approval
- Study/Work Product Updates
- Site Visit – TBD

Next Scheduled Meeting

January 9, 2019
Location: Merwin HCC

Attachments:

- November 14, 2018 Meeting Agenda
- **Attachment A** – Eagle Island Upland Restoration Project Progress Report, November 6, 2018
- **Attachment B** – Devil’s Backbone Patch Cut and Forage Seeding Project Costs / Revenue, November 14, 2018 and DNR approval for Alternative Plan designation
- **Attachment C** - Criteria for Determining Type of Northern Goshawk Survey required prior to Commercial Thinning a Timber Harvest Area, November 14, 2018
- **Attachment D** – Email exchange with DNR regarding Devil’s Backbone “alternate plan” designation – November 14 – 16, 2018

Adjourn 12:25pm

McCune, Kimberly

From: McCune, Kimberly
Sent: Wednesday, November 14, 2018 3:23 PM
To: 'Adam Cole'; 'Amanda Froberg'; 'Amelia Johnson'; 'Bill Richardson'; 'Bob Nelson'; 'Chartier, Neil - FS'; Emmerson, Kendel; 'Eric Holman'; 'Erik White'; 'James H Malinowski'; 'John Clapp'; 'Mariah Stoll-Smith Reese'; 'Michelle Day'; 'Nathan Reynolds'; Olson, Todd; 'Patrick Lee'; 'Peggy Miller'; Peterman, Summer; 'Ray Crosswell'; 'Ruth Tracy'; 'Steve Manlow'; 'Tim Romanski'
Subject: 10.3.3 Matching Funds Eagle Island Project; Status Report
Attachments: 11072018 WDFW Progress Report_Eagle Island.pdf

Attn: TCC Representatives

Please find attached the Eagle Island Project status report provided by Daren Hauswald at WDFW.

Parking Lot Items	Status
WDFW: In regards to 10.3.3, Matching Funds Eagle Island Project the TCC would like a 1-2-page progress report of project status with photos after the grant term expires (12-31-2017).	Complete – 11/14/18

Thank you.

K

From: Hauswald, Daren B (DFW) [<mailto:Daren.Hauswald@dfw.wa.gov>]
Sent: Wednesday, November 07, 2018 3:34 PM
To: McCune, Kimberly <Kimberly.McCune@pacificorp.com>
Subject: RE: TCC 11/14/18 Meeting Agenda, TCC Draft 10/10/18 Meeting Notes

Kim,
Sorry that I did not get this report to you sooner, and I apologize for not being able to attend the meeting next week. Please let me know if you have any questions on the report or if there is anything else that I need to address.

Thank you,
Daren Hauswald
Wildlife Area Manager
Shillapoo and Mt. St. Helens Complex
360-906-6756

From: McCune, Kimberly <Kimberly.McCune@pacificorp.com>
Sent: Wednesday, November 7, 2018 11:42 AM
To: Cole, Adam (RCO) <adam.cole@rco.wa.gov>; Amanda Froberg <afroberg@cowlitzpud.org>; Amelia Johnson <ajohnson@lcfwb.gen.wa.us>; Bill Richardson <brichardson@RMEF.org>; Bob Nelson <nelson338@aol.com>; Chartier, Neil - FS <nchartier@fs.fed.us>; Emmerson, Kendel <Kendel.Emmerson@pacificorp.com>; Holman, Eric W (DFW) <Eric.Holman@dfw.wa.gov>; Erik White <ewhite@cowlitz.org>; James H Malinowski <jim.malinowski@icloud.com>; John Clapp <jmcmacle@gmail.com>; Mariah Stoll-Smith Reese <mariah@lelooska.org>; Michelle Day

<michelle.day@noaa.gov>; Nathan Reynolds <nreynolds@cowlitz.org>; Olson, Todd <Todd.Olson@pacificorp.com>; Patrick Lee <patrick.lee@clark.wa.gov>; Miller, Peggy A (DFW) <Peggy.Miller@dfw.wa.gov>; Peterman, Summer <Summer.Peterman@pacificorp.com>; Ray Croswell <shedhunt@aol.com>; Ruth Tracy <rtracy@fs.fed.us>; Steve Manlow <smanlow@lcfwb.gen.wa.us>; Tim Romanski <tim_romanski@fws.gov>
Cc: Hauswald, Daren B (DFW) <Daren.Hauswald@dfw.wa.gov>
Subject: TCC 11/14/18 Meeting Agenda, TCC Draft 10/10/18 Meeting Notes

Attn: TCC Representatives

Please find attached the TCC 11/14/18 Meeting Agenda and the TCC Draft 10/10/18 Meeting Notes for your review.

Thank you.

Kimberly McCune

Sr. Business Administrator

PacifiCorp – Hydro Resources

825 NE Multnomah St., Suite 1800

Portland, OR 97232

Ph: (503) 813-6078

Eagle Island Upland Restoration

Project Progress Report

11/06/18

This progress report details the work completed and expenditures to date for the Eagle Island Upland Restoration project. Funds for the restoration work on Eagle Island were approved by Terrestrial Coordination Committee (TCC) in 2016, and allocated to WDFW in 2017 for the amount of \$16,500. Additional 10.3.3 funds were requested by WDFW and approved by TCC at the June 2018 meeting, however these additional funds ended up not being required, as bids from contractors to mow the scotch broom on the island came in lower than expected. This is the final report for the allocation of the funds approved in 2016 to do wildlife habitat restoration work on the Eagle Island Unit of the Mt. St. Helens Wildlife Area.

The funds approved for this restoration work were used as proposed to remove scotch broom from roughly 100 acres in the upland areas on Eagle Island. This past August, the 10.3.3 funds were used to hire NRC Environmental Services to mow scotch broom and other brush on the island. The contractor accomplished this using two skid-steers with rotary mowers attached, which took approximately five days, and totaled about 100 hours of equipment operation. The total costs for the mowing came to \$22,724.24.

Project Expenditures Table

Activity	WDFW Expenditures	PacifiCorps Expenditures
Aerial Spraying	\$10,500	\$0
Knotweed Treatments	\$3,635	\$0
Administrative/Permitting	\$1,268	\$0
Scotch broom Mowing	\$6,224	\$16,500
Total	\$21,627	\$16,500

To date the upland restoration work has included the aerial spraying of 100 acres of scotch broom, knotweed treatments, and the mowing of the dead scotch broom. Due to the steepness of the riverbank and large debris in the blackberry thickets and in some of the scotch broom, the contractors were not able to mow the outer edges of the island. This outside ring of brush will be treated by WDFW and/or contractors in the upcoming years to help with restoring the riparian areas of the island. WDFW also plans on monitoring and retreating the scotch broom areas that were mowed as needed.

Waterfowl surveys will also be conducted to determine if geese are foraging in the newly open meadow areas where the scotch broom was removed. Other monitoring may include songbird counts, nesting surveys for waterfowl and songbirds, deer surveys, and vegetation surveys. This would all start to occur in 2019.

In the upcoming year WDFW plans to plant trees and shrubs in selected areas as test plots to determine which species of plants grow best and if a floodplain forest could be established along certain areas of the island. Due to the soil being sandy on the portion of the island where the scotch broom was removed, establishing trees and shrubs may be difficult. To help increase success of getting plants established only

species that have reasonable to high drought tolerance will be planted. These species would include black cottonwood, black hawthorn, Oregon ash, serviceberry, and Oregon oak.

Funding for this restoration work has helped to decrease invasive weeds and increase wildlife habitat in both quality and quantity. Plans are to continue to make progress in removing invasive vegetation on the island, mow portions of the meadow areas annually, and plant native vegetation to enhance wildlife habitat. As with the past restoration activities, these future actions will likely need additional funding to accomplish. WDFW thanks PacifiCorps and the members of the Terrestrial Coordination Committee for providing funding for the restoration work and hopes that future funding will also be available for continued restoration and wildlife habitat enhancements.



Eagle Island Upland Restoration

Project Progress Report

11/06/18

This progress report details the work completed and expenditures to date for the Eagle Island Upland Restoration project. Funds for the restoration work on Eagle Island were approved by Terrestrial Coordination Committee (TCC) in 2016, and allocated to WDFW in 2017 for the amount of \$16,500. Additional 10.3.3 funds were requested by WDFW and approved by TCC at the June 2018 meeting, however these additional funds ended up not being required, as bids from contractors to mow the scotch broom on the island came in lower than expected. This is the final report for the allocation of the funds approved in 2016 to do wildlife habitat restoration work on the Eagle Island Unit of the Mt. St. Helens Wildlife Area.

The funds approved for this restoration work were used as proposed to remove scotch broom from roughly 100 acres in the upland areas on Eagle Island. This past August, the 10.3.3 funds were used to hire NRC Environmental Services to mow scotch broom and other brush on the island. The contractor accomplished this using two skid-steers with rotary mowers attached, which took approximately five days, and totaled about 100 hours of equipment operation. The total costs for the mowing came to \$22,724.24.

Project Expenditures Table

Activity	WDFW Expenditures	PacifiCorps Expenditures
Aerial Spraying	\$10,500	\$0
Knotweed Treatments	\$3,635	\$0
Administrative/Permitting	\$1,268	\$0
Scotch broom Mowing	\$6,224	\$16,500
Total	\$21,627	\$16,500

To date the upland restoration work has included the aerial spraying of 100 acres of scotch broom, knotweed treatments, and the mowing of the dead scotch broom. Due to the steepness of the riverbank and large debris in the blackberry thickets and in some of the scotch broom, the contractors were not able to mow the outer edges of the island. This outside ring of brush will be treated by WDFW and/or contractors in the upcoming years to help with restoring the riparian areas of the island. WDFW also plans on monitoring and retreating the scotch broom areas that were mowed as needed.

Waterfowl surveys will also be conducted to determine if geese are foraging in the newly open meadow areas where the scotch broom was removed. Other monitoring may include songbird counts, nesting surveys for waterfowl and songbirds, deer surveys, and vegetation surveys. This would all start to occur in 2019.

In the upcoming year WDFW plans to plant trees and shrubs in selected areas as test plots to determine which species of plants grow best and if a floodplain forest could be established along certain areas of the island. Due to the soil being sandy on the portion of the island where the scotch broom was removed, establishing trees and shrubs may be difficult. To help increase success of getting plants established only

species that have reasonable to high drought tolerance will be planted. These species would include black cottonwood, black hawthorn, Oregon ash, serviceberry, and Oregon oak.

Funding for this restoration work has helped to decrease invasive weeds and increase wildlife habitat in both quality and quantity. Plans are to continue to make progress in removing invasive vegetation on the island, mow portions of the meadow areas annually, and plant native vegetation to enhance wildlife habitat. As with the past restoration activities, these future actions will likely need additional funding to accomplish. WDFW thanks PacifiCorps and the members of the Terrestrial Coordination Committee for providing funding for the restoration work and hopes that future funding will also be available for continued restoration and wildlife habitat enhancements.



Devils Backbone Patch Cut and Forage Seeding Project Costs

Logging costs based on information provided by Joe Barry, Chilton Logging in January 2018.

Prescription Summary: Clearcut patch of 5.8 acres, pull stumps, burn stumps and residual slash, and seed the area with a forage / grass seed mix. Estimated 247 mbf merchantable volume within entire patch.

	Logging	Stumping	Total
Cost	\$ / mbf	\$ / mbf	247 mbf
Logging Cost (\$/mbf)	\$178	\$77	
Mobilization Cost (\$/mbf)	\$13	\$6	
Hauling Cost (\$/mbf)	\$86	\$0	
Total Cost (\$/mbf)	\$277	\$83	
2019 Project	\$68,419	\$20,501	\$88,920

Estimate of incremental cost of pulling stumps.

Description	\$ / mbf
With Pulling Stumps	
Logging	\$255
Mobilization	\$19
Total \$ / mbf	\$274
Without Pulling Stumps	
Logging	\$178
Mobilization	\$13
Total \$ / mbf	\$191
Stumping Costs \$ / mbf	\$83
Total Stumping Cost (247 mbf)	\$20,501

Additional Lump Sum Costs - 2020

Pile Burning	\$6,200	Day 1: Crew of 6 x 10 hrs. x \$50/hr. = \$3,000 Two pickup, water pump trucks \$300/day = \$600 Day 2: Crew of 2 x 8 hrs. x \$50/hr. = \$800 One pickup, water pump truck \$300/day = \$300 Burn permitting = \$1,500
Forage Seeding	\$770	2 people x 2 days x 8 hrs. x \$30/hr. = \$480 Seed costs \$50/acre x 5.8 acres = \$290

McCune, Kimberly

To: McCune, Kimberly
Subject: RE: Devils Backbone Patch Cut FPA

From: Amanda Froberg [<mailto:afroberg@cowlitzpud.org>]
Sent: Friday, November 16, 2018 11:57 AM
To: Emmerson, Kendel <Kendel.Emmerson@pacificorp.com>; Peterman, Summer <Summer.Peterman@pacificorp.com>; McCune, Kimberly <Kimberly.McCune@pacificorp.com>; 'nreynolds@cowlitz.org' <nreynolds@cowlitz.org>; 'ewhite@cowlitz.org' <ewhite@cowlitz.org>; 'brichardson@RMEF.org' <brichardson@RMEF.org>; 'shedhunt@aol.com' <shedhunt@aol.com>; 'Miller, Peggy A (DFW)' <Peggy.Miller@dfw.wa.gov>; 'holmaewh@dfw.wa.gov' <holmaewh@dfw.wa.gov>
Cc: 'jberry@chiltonlogging.com' <jberry@chiltonlogging.com>
Subject: FW: Devils Backbone Patch Cut FPA

Hi All,
Please see below. After more discussions and emails, DNR has granted the Devil's Backbone Patch Cut to be covered under the Alternative Plan. Thanks for the phone discussions I had with many of you after the meeting!
Thank you,
Amanda

Amanda Froberg

Environmental Compliance Manager · Cowlitz PUD

961 12th Avenue · PO Box 3007 · Longview, WA 98632 · BLOCKEDcowlitzpud@.orgBLOCKED
P: 360.501.9374 · E: afroberg@cowlitzpud.org



From: DNR RE FP PC <pcforestpractices@dnr.wa.gov>
Sent: Thursday, November 15, 2018 2:39 PM
To: Amanda Froberg <afroberg@cowlitzpud.org>
Subject: RE: Devils Backbone Patch Cut FPA

EXTERNAL: Think Before You Click!

Hi Amanda,

I spoke with my District Manager, and we agree that in this specific case an alternate plan could be used to deviate from the reforestation requirement. This is the first time I've seen an alternate plan used in this way, but it seems to be allowable within WAC 222-12-040 and 222-12-0401. Please send me the alternate plan forms that reflect 5.8 acres of harvest and we will go ahead and process this application as a Class III (no additional fee required). I will be letting our Forest Practices Division know about this one just in case there is some legal WAC or RCW requirement that I'm not thinking of.

Thank you,

Taylor Mizar

Forest Practices Coordinator

Pacific Cascade Region

Washington Department of Natural Resources (DNR)

Office: 360-575-5039

Mobile: 360-957-8145

taylor.mizar@dnr.wa.gov

www.dnr.wa.gov

From: Amanda Froberg <afroberg@cowlitzpud.org>

Sent: Wednesday, November 14, 2018 4:59 PM

To: DNR RE FP PC <pcforestpractices@dnr.wa.gov>

Subject: RE: Devils Backbone Patch Cut FPA

Hi Taylor,

Today was our monthly meeting with the Lewis River Terrestrial Coordinating Committee, members of state and federal agencies responsible for directing the management of wildlife habitat in the Lewis River watershed, members include but are not limited to WDFW, RMEF, USFS, USFWS, NOAA, and Cowlitz Tribe. They direct and approve Cowlitz PUD management of our Wildlife Habitat Management Plan Lands (525 acres). These lands are managed to improve the habitat for wildlife, particularly big game species, over the long-term. They were concerned regarding the conversion issue that we are facing with the 5.8 acre Devil's Backbone Elk Forage Plot and wanted me to ask a few questions:

Is the alternate plan not the mechanism for doing something that isn't traditional forestry, if it is not could you please point us in the right direction to a potential provision?

What is allowed within an alternate plan, are there any changes we need to make to our submitted alternate plan to have our habitat management activity covered?

We are creating the opening for habitat restoration purposes and the 5.8 acres will not be developed. What are DNR's concerns so that we can address and consider a path going forward?

The TCC (WDFW, Cowlitz Tribe and RMEF) is willing to write a letter of support for the project/alternate plan. If that would be helpful please let me know so that I can let them know.

Thank you for your time and assistance,
Amanda

Amanda Froberg

Environmental Compliance Manager · Cowlitz PUD

961 12th Avenue · PO Box 3007 · Longview, WA 98632 · [BLOCKEDcowlitzpud\[.\]orgBLOCKED](mailto:afroberg@cowlitzpud.org)

P: 360.501.9374 · E: afroberg@cowlitzpud.org



Criteria for Determining Type of Northern Goshawk Survey required prior to Commercial Thinning (CT) a Timber Harvest Area (THA)

Survey Category	Size of THA			THA potential to be within a Nest Area Cluster (NAC)		Post-fledgling family Area (PFA)	THA boundary is comprised of one or more Vegetation Cover type (VCT)	Type of Survey
	≥9.88 Acres	<9.88 acres	THA is < 2.0 acres in size and 200 feet in width	THA boundary is < 1148.3 ft. from M or OG vegetation cover type and not separated by a reservoir	THA boundary is > 1148.3 ft. and < 1570.6 ft. from M or OG vegetation cover type and not separated by a reservoir	THA boundary is > 1570.6 ft. and < 2879.3 ft. from M or OG vegetation cover type and not separated by a reservoir		
1	Yes	No	No	Not Applicable	Not Applicable	Not Applicable	LP, M, M-t, MS, MS-t, OW, OG, OG-t, PFO, RD, RD-t, RM, RM-t, UD, UD-t, UM, UM-t	Broadcast Acoustical Survey
2	no	Yes	No	Not Applicable	Not Applicable	Not Applicable	M, M-t, OG, or OG-t	Broadcast Acoustical Survey
3	Yes	No	No	No	No	No	Not Applicable	No survey required
4	no	Yes	No	No	No	No	Not Applicable	No survey required
5	Yes	no	No	Yes	No	Not Applicable	Not Applicable	Broadcast Acoustical Survey
6	Yes	No	No	No	Yes	Not Applicable	Not Applicable	No survey if tree removal is trees < 21 in. dbh. and harvesting occurs between 9/1 to 2/28 otherwise Intensive Search Survey
7	no	Yes	No	Yes	No	Not Applicable	Not Applicable	Broadcast Acoustical Survey
8	no	Yes	No	no	Yes	not Applicable	Not Applicable	No survey if tree removal is trees < 21 in. dbh. and harvesting occurs between 9/1 to 2/28 otherwise Intensive Search Survey
9	no	No	Yes	no	no	Yes	Not Applicable	No survey if tree removal is trees < 21 in. dbh. and harvesting occurs between 9/1 to 2/28 otherwise Intensive Search Survey
10	no	Yes	No	no	no	Yes	Not Applicable	Intensive Survey unless removing trees ≥21 in dbh, then Broadcast Acoustical Survey
11	yes	No	No	No	No	yes	Not Applicable	Complete habitat analysis to determine level of survey

It is assumed that commercial thinning will only change the vegetation cover type to the same VCT only thinned. For example MS becomes MS-t, therefore a habitat analysis would not be required.

CATEGORY	Type of Survey	HARVEST_ID	ACRES	UNIT	YEAR	AREA_NM
1	Broadcast Acoustical Survey	170112 CC	23.93	1	2017	SKULL CANDY
1	Broadcast Acoustical Survey	160335 CC	13.09	3	2016	<Null>
1	Broadcast Acoustical Survey	130450 CC	14.91	4	2013	<Null>
1	Broadcast Acoustical Survey	150526 CC	19.3	5	2015	<Null>
1	Broadcast Acoustical Survey	120685 CC	23.94	6	2012	<Null>
1	Broadcast Acoustical Survey	840718 CC	12.62	7	1984	<Null>
1	Broadcast Acoustical Survey	160773 CC	26.51	7	2016	<Null>
1	Broadcast Acoustical Survey	170838 CC	13.79	8	2017	MANITCH
1	Broadcast Acoustical Survey	990935 CC	10.99	9	1999	<Null>
1	Broadcast Acoustical Survey	101126 CC	18.32	11	2010	<Null>
1	Broadcast Acoustical Survey	041237 CC	17.11	12	2004	<Null>
1	Broadcast Acoustical Survey	181549 CC	11.03	15	2018	MULLET
1	Broadcast Acoustical Survey	101801 CC	26.86	18	2010	<Null>
1	Broadcast Acoustical Survey	842301 CC	22.46	23	1984	<Null>
1	Broadcast Acoustical Survey	113320 CC	17.64	33	2011	<Null>
3	No Survey Required	752001 CC	23.07	20	1975	<Null>
3	No Survey Required	932003 CC	39.89	20	1993	<Null>
3	No Survey Required	952004 CC	10.86	20	1995	<Null>
3	No Survey Required	122502 CC	9.96	25	2012	<Null>
3	No Survey Required	183402 CC	12.07	34	2018	YUKON
3	No Survey Required	183403 CC	18.35	34	2018	RUDOLF
3	No Survey Required	153501 CC	47.3	35	2015	<Null>
3	No Survey Required	133709 CC	15.12	37	2013	<Null>
3	No Survey Required	133905 CC	30.89	39	2013	<Null>
3	No Survey Required	143961 CC	39.36	39	2014	<Null>
3	No Survey Required	143962 CC	47.53	39	2014	<Null>
3	No Survey Required	143963 CC	11.75	39	2014	<Null>
3	No Survey Required	153971 CC	36.34	39	2015	<Null>
3	No Survey Required	153972 CC	28.36	39	2015	<Null>
4	No Survey Required	820512 CC	2.26	5	1982	<Null>
4	No Survey Required	880756 CC	5.56	7	1988	<Null>
4	No Survey Required	880757 CC	6.4	7	1988	<Null>
4	No Survey Required	000768 CC	8	7	2000	<Null>
4	No Survey Required	050771 CC	2.45	7	2005	<Null>
4	No Survey Required	170776 CC	1.33	7	2017	HAMMROT
4	No Survey Required	980836 CC	9.72	8	1998	<Null>
4	No Survey Required	952005 CC	5.53	20	1995	<Null>
4	No Survey Required	163656 CC	2.44	36	2016	<Null>
4	No Survey Required	043771 CC	6.95	37	2004	<Null>
5	Broadcast Acoustical Survey	960108 CC	12.19	1	1996	<Null>
5	Broadcast Acoustical Survey	020110 CC	10.22	1	2002	<Null>
5	Broadcast Acoustical Survey	880226 CC	22.08	2	1988	<Null>
5	Broadcast Acoustical Survey	990229 CC	9.94	2	1999	<Null>

CATEGORY	Type of Survey	HARVEST_ID	ACRES	UNIT	YEAR	AREA_NM
5	Broadcast Acoustical Survey	860309 CC	28.16	3	1986	<Null>
5	Broadcast Acoustical Survey	880328 CC	13.12	3	1988	<Null>
5	Broadcast Acoustical Survey	980331 CC	13.14	3	1998	<Null>
5	Broadcast Acoustical Survey	050332 CC	11.39	3	2005	<Null>
5	Broadcast Acoustical Survey	870415 CC	14.75	4	1987	<Null>
5	Broadcast Acoustical Survey	900437 CC	13.44	4	1990	<Null>
5	Broadcast Acoustical Survey	900438 CC	10.92	4	1990	<Null>
5	Broadcast Acoustical Survey	010443 CC	13.35	4	2001	<Null>
5	Broadcast Acoustical Survey	130448 CC	15.69	4	2013	<Null>
5	Broadcast Acoustical Survey	830633 CC	10.55	6	1983	<Null>
5	Broadcast Acoustical Survey	890662 CC	14.9	6	1989	<Null>
5	Broadcast Acoustical Survey	910664 CC	13.7	6	1991	<Null>
5	Broadcast Acoustical Survey	970671 CC	19.25	6	1997	<Null>
5	Broadcast Acoustical Survey	030677 CC	16.85	6	2003	<Null>
5	Broadcast Acoustical Survey	120684 CC	13.94	6	2012	<Null>
5	Broadcast Acoustical Survey	840772 CC	13.56	7	1984	<Null>
5	Broadcast Acoustical Survey	840907 CC	10.23	9	1984	<Null>
5	Broadcast Acoustical Survey	840921 CC	12.82	9	1984	<Null>
5	Broadcast Acoustical Survey	920932 CC	13.82	9	1992	<Null>
5	Broadcast Acoustical Survey	920933 CC	14.44	9	1992	<Null>
5	Broadcast Acoustical Survey	990934 CC	14.17	9	1999	<Null>
5	Broadcast Acoustical Survey	020936 CC	10.25	9	2002	<Null>
5	Broadcast Acoustical Survey	141009 CC	24.81	10	2014	<Null>
5	Broadcast Acoustical Survey	861103 CC	27.95	11	1986	<Null>
5	Broadcast Acoustical Survey	901117 CC	12.96	11	1990	<Null>
5	Broadcast Acoustical Survey	001125 CC	13.06	11	2000	<Null>
5	Broadcast Acoustical Survey	101127 CC	12.42	11	2010	<Null>
5	Broadcast Acoustical Survey	871220 CC	13.15	12	1987	<Null>
5	Broadcast Acoustical Survey	971235 CC	11.47	12	1997	<Null>
5	Broadcast Acoustical Survey	021236 CC	18.45	12	2002	<Null>
5	Broadcast Acoustical Survey	051238 CC	25.07	12	2005	<Null>
5	Broadcast Acoustical Survey	171401 CC	22.98	14	2017	MIDDLE EARTH
5	Broadcast Acoustical Survey	841523 CC	3.59	15	1984	<Null>
5	Broadcast Acoustical Survey	841546 CC	11.08	15	1984	<Null>
5	Broadcast Acoustical Survey	891535 CC	22.27	15	1989	<Null>
5	Broadcast Acoustical Survey	951537 CC	17.15	15	1995	<Null>
5	Broadcast Acoustical Survey	121547 CC	16.4	15	2012	<Null>
5	Broadcast Acoustical Survey	851615 CC	35.48	16	1985	<Null>
5	Broadcast Acoustical Survey	851630 CC	62.85	16	1985	<Null>
5	Broadcast Acoustical Survey	991702 CC	34.87	17	1999	<Null>
5	Broadcast Acoustical Survey	091703 CC	22.49	17	2009	<Null>
5	Broadcast Acoustical Survey	091704 CC	14.41	17	2009	<Null>
5	Broadcast Acoustical Survey	091705 CC	11.21	17	2009	<Null>

CATEGORY	Type of Survey	HARVEST_ID	ACRES	UNIT	YEAR	AREA_NM
5	Broadcast Acoustical Survey	912002 CC	10.4	20	1991	<Null>
5	Broadcast Acoustical Survey	952007 CC	16.49	20	1995	<Null>
5	Broadcast Acoustical Survey	952008 CC	11.55	20	1995	<Null>
5	Broadcast Acoustical Survey	132010 CC	31.17	20	2013	<Null>
5	Broadcast Acoustical Survey	082604 CC	11.4	26	2008	<Null>
5	Broadcast Acoustical Survey	043304 CC	11.48	33	2004	<Null>
5	Broadcast Acoustical Survey	043305 CC	30.62	33	2004	<Null>
5	Broadcast Acoustical Survey	043332 CC	24.73	33	2004	<Null>
5	Broadcast Acoustical Survey	043333 CC	18.09	33	2004	<Null>
5	Broadcast Acoustical Survey	063307 CC	20	33	2006	<Null>
5	Broadcast Acoustical Survey	063309 CC	43.36	33	2006	<Null>
5	Broadcast Acoustical Survey	063311 CC	52.24	33	2006	<Null>
5	Broadcast Acoustical Survey	133317 CC	20.55	33	2011	<Null>
5	Broadcast Acoustical Survey	113318 CC	24.14	33	2011	<Null>
5	Broadcast Acoustical Survey	883621 CC	32.53	36	1988	<Null>
5	Broadcast Acoustical Survey	043631 CC	11.93	36	2004	<Null>
5	Broadcast Acoustical Survey	043632 CC	40.76	36	2004	<Null>
5	Broadcast Acoustical Survey	053641 CC	50.13	36	2005	<Null>
5	Broadcast Acoustical Survey	053643 CC	47.57	36	2005	<Null>
5	Broadcast Acoustical Survey	163654 CC	42.2	36	2016	<Null>
5	Broadcast Acoustical Survey	163655 CC	40.16	36	2016	<Null>
5	Broadcast Acoustical Survey	923701 CC	71.44	37	1992	<Null>
5	Broadcast Acoustical Survey	013703 CC	39.07	37	2001	<Null>
5	Broadcast Acoustical Survey	043761 CC	31.87	37	2004	<Null>
5	Broadcast Acoustical Survey	043762 CC	28.97	37	2004	<Null>
5	Broadcast Acoustical Survey	023803 CC	31.8	38	2002	<Null>
5	Broadcast Acoustical Survey	033804 CC	61.89	38	2003	<Null>
5	Broadcast Acoustical Survey	053801 CC	34.27	38	2005	<Null>
5	Broadcast Acoustical Survey	053802 CC	52.46	38	2005	<Null>
5	Broadcast Acoustical Survey	163807 CC	18.38	38	2016	<Null>
5	Broadcast Acoustical Survey	073911 CC	19.4	39	2007	<Null>
5	Broadcast Acoustical Survey	073912 CC	32.75	39	2007	<Null>
5	Broadcast Acoustical Survey	123932 CC	24.96	39	2012	<Null>
6	No survey if tree removal is trees < 21 in. dbh. and harvesting occurs between 9/1 to 2/28 otherwise Intensive Search Survey	030447 CC	24.6	4	2003	<Null>
6	No survey if tree removal is trees < 21 in. dbh. and harvesting occurs between 9/1 to 2/28 otherwise Intensive Search Survey	040527 CC	16.26	5	2004	<Null>

CATEGORY	Type of Survey	HARVEST_ID	ACRES	UNIT	YEAR	AREA_NM
6	No survey if tree removal is trees < 21 in. dbh. and harvesting occurs between 9/1 to 2/28 otherwise Intensive Search Survey	880758 CC	11.15	7	1988	<Null>
6	No survey if tree removal is trees < 21 in. dbh. and harvesting occurs between 9/1 to 2/28 otherwise Intensive Search Survey	050770 CC	24.81	7	2005	<Null>
6	No survey if tree removal is trees < 21 in. dbh. and harvesting occurs between 9/1 to 2/28 otherwise Intensive Search Survey	010837 CC	13.35	8	2001	<Null>
6	No survey if tree removal is trees < 21 in. dbh. and harvesting occurs between 9/1 to 2/28 otherwise Intensive Search Survey	890931 CC	21.81	9	1989	<Null>
6	No survey if tree removal is trees < 21 in. dbh. and harvesting occurs between 9/1 to 2/28 otherwise Intensive Search Survey	141007 CC	22.73	10	2014	<Null>
6	No survey if tree removal is trees < 21 in. dbh. and harvesting occurs between 9/1 to 2/28 otherwise Intensive Search Survey	991701 CC	25.96	17	1999	<Null>
6	No survey if tree removal is trees < 21 in. dbh. and harvesting occurs between 9/1 to 2/28 otherwise Intensive Search Survey	862601 CC	30.8	26	1986	<Null>
6	No survey if tree removal is trees < 21 in. dbh. and harvesting occurs between 9/1 to 2/28 otherwise Intensive Search Survey	063308 CC	23.53	33	2006	<Null>

CATEGORY	Type of Survey	HARVEST_ID	ACRES	UNIT	YEAR	AREA_NM
6	No survey if tree removal is trees < 21 in. dbh. and harvesting occurs between 9/1 to 2/28 otherwise Intensive Search Survey	133316 CC	31.82	33	2011	<Null>
6	No survey if tree removal is trees < 21 in. dbh. and harvesting occurs between 9/1 to 2/28 otherwise Intensive Search Survey	883622 CC	27.05	36	1988	<Null>
6	No survey if tree removal is trees < 21 in. dbh. and harvesting occurs between 9/1 to 2/28 otherwise Intensive Search Survey	053642 CC	52.81	36	2005	<Null>
6	No survey if tree removal is trees < 21 in. dbh. and harvesting occurs between 9/1 to 2/28 otherwise Intensive Search Survey	163653 CC	20.18	36	2016	<Null>
6	No survey if tree removal is trees < 21 in. dbh. and harvesting occurs between 9/1 to 2/28 otherwise Intensive Search Survey	123931 CC	31.37	39	2012	<Null>
6	No survey if tree removal is trees < 21 in. dbh. and harvesting occurs between 9/1 to 2/28 otherwise Intensive Search Survey	163982 CC	21.44	39	2016	<Null>
6	No survey if tree removal is trees < 21 in. dbh. and harvesting occurs between 9/1 to 2/28 otherwise Intensive Search Survey	163983 CC	49.46	39	2016	<Null>
7	Broadcast Acoustical Survey	840107 CC	2.21	1	1984	<Null>
7	Broadcast Acoustical Survey	170111 CC	4.93	1	2017	BEATS
7	Broadcast Acoustical Survey	900225 CC	7.28	2	1990	<Null>
7	Broadcast Acoustical Survey	900227 CC	5.18	2	1990	<Null>
7	Broadcast Acoustical Survey	020231 CC	1.95	2	2002	<Null>
7	Broadcast Acoustical Survey	020232 CC	9.31	2	2002	<Null>
7	Broadcast Acoustical Survey	020233 CC	2.97	2	2002	<Null>
7	Broadcast Acoustical Survey	820318 CC	5.72	3	1982	<Null>
7	Broadcast Acoustical Survey	980329 CC	2.31	3	1998	<Null>

CATEGORY	Type of Survey	HARVEST_ID	ACRES	UNIT	YEAR	AREA_NM
7	Broadcast Acoustical Survey	980330 CC	7.07	3	1998	<Null>
7	Broadcast Acoustical Survey	050333 CC	1.19	3	2005	<Null>
7	Broadcast Acoustical Survey	930440 CC	1.03	4	1993	<Null>
7	Broadcast Acoustical Survey	930441 CC	0.42	4	1993	<Null>
7	Broadcast Acoustical Survey	930442 CC	2.34	4	1993	<Null>
7	Broadcast Acoustical Survey	010444 CC	4.85	4	2001	<Null>
7	Broadcast Acoustical Survey	010445 CC	9.32	4	2001	<Null>
7	Broadcast Acoustical Survey	020446 CC	0.8	4	2002	<Null>
7	Broadcast Acoustical Survey	130449 CC	1.68	4	2013	<Null>
7	Broadcast Acoustical Survey	040528 CC	5.09	5	2004	<Null>
7	Broadcast Acoustical Survey	830621 CC	1.7	6	1983	<Null>
7	Broadcast Acoustical Survey	860631 CC	1.84	6	1986	<Null>
7	Broadcast Acoustical Survey	860632 CC	1.57	6	1986	<Null>
7	Broadcast Acoustical Survey	860636 CC	0.79	6	1986	<Null>
7	Broadcast Acoustical Survey	860637 CC	4.79	6	1986	<Null>
7	Broadcast Acoustical Survey	860639 CC	1.04	6	1986	<Null>
7	Broadcast Acoustical Survey	860646 CC	8.3	6	1986	<Null>
7	Broadcast Acoustical Survey	880660 CC	1.96	6	1988	<Null>
7	Broadcast Acoustical Survey	880661 CC	1	6	1988	<Null>
7	Broadcast Acoustical Survey	890663 CC	7.55	6	1989	<Null>
7	Broadcast Acoustical Survey	960668 CC	6.09	6	1996	<Null>
7	Broadcast Acoustical Survey	980673 CC	4.92	6	1998	<Null>
7	Broadcast Acoustical Survey	980674 CC	8.74	6	1998	<Null>
7	Broadcast Acoustical Survey	030678 CC	7.77	6	2003	<Null>
7	Broadcast Acoustical Survey	030679 CC	8.87	6	2003	<Null>
7	Broadcast Acoustical Survey	030680 CC	5.82	6	2003	<Null>
7	Broadcast Acoustical Survey	030681 CC	0.61	6	2003	<Null>
7	Broadcast Acoustical Survey	030682 CC	8.14	6	2003	<Null>
7	Broadcast Acoustical Survey	120686 CC	4.14	6	2012	<Null>
7	Broadcast Acoustical Survey	890745 CC	7.36	7	1989	<Null>
7	Broadcast Acoustical Survey	950759 CC	2.18	7	1995	<Null>
7	Broadcast Acoustical Survey	950760 CC	8.83	7	1995	<Null>
7	Broadcast Acoustical Survey	970767 CC	4.43	7	1997	<Null>
7	Broadcast Acoustical Survey	170775 CC	1.43	7	2017	FISHROT
7	Broadcast Acoustical Survey	880834 CC	7.41	8	1988	<Null>
7	Broadcast Acoustical Survey	841006 CC	3.05	10	1984	<Null>
7	Broadcast Acoustical Survey	141008 CC	8.57	10	2014	<Null>
7	Broadcast Acoustical Survey	901119 CC	1.29	11	1990	<Null>
7	Broadcast Acoustical Survey	991122 CC	6.91	11	1999	<Null>
7	Broadcast Acoustical Survey	991123 CC	0.98	11	1999	<Null>
7	Broadcast Acoustical Survey	001124 CC	7.82	11	2000	<Null>
7	Broadcast Acoustical Survey	871202 CC	8.37	12	1987	<Null>
7	Broadcast Acoustical Survey	871214 CC	5.97	12	1987	<Null>
7	Broadcast Acoustical Survey	911231 CC	4.91	12	1991	<Null>

CATEGORY	Type of Survey	HARVEST_ID	ACRES	UNIT	YEAR	AREA_NM
7	Broadcast Acoustical Survey	911232 CC	0.81	12	1991	<Null>
7	Broadcast Acoustical Survey	971234 CC	4.8	12	1997	<Null>
7	Broadcast Acoustical Survey	051239 CC	7.7	12	2005	<Null>
7	Broadcast Acoustical Survey	841522 CC	6.11	15	1984	<Null>
7	Broadcast Acoustical Survey	871510 CC	1.86	15	1987	<Null>
7	Broadcast Acoustical Survey	871514 CC	5	15	1987	<Null>
7	Broadcast Acoustical Survey	951538 CC	8.02	15	1995	<Null>
7	Broadcast Acoustical Survey	001541 CC	4.65	15	2000	<Null>
7	Broadcast Acoustical Survey	001542 CC	4.37	15	2000	<Null>
7	Broadcast Acoustical Survey	001543 CC	5.78	15	2000	<Null>
7	Broadcast Acoustical Survey	001544 CC	4.67	15	2000	<Null>
7	Broadcast Acoustical Survey	001545 CC	1.2	15	2000	<Null>
7	Broadcast Acoustical Survey	181551 CC	9.63	15	2018	HIGSLY II
7	Broadcast Acoustical Survey	851616 CC	6.99	16	1985	<Null>
7	Broadcast Acoustical Survey	921631 CC	9.09	16	1992	<Null>
7	Broadcast Acoustical Survey	921632 CC	4.37	16	1992	<Null>
7	Broadcast Acoustical Survey	921633 CC	3.64	16	1992	<Null>
7	Broadcast Acoustical Survey	861903 CC	2.39	19	1986	<Null>
7	Broadcast Acoustical Survey	002009 CC	1.43	20	2000	<Null>
7	Broadcast Acoustical Survey	842302 CC	7.25	23	1984	<Null>
7	Broadcast Acoustical Survey	082603 CC	8.21	26	2008	<Null>
7	Broadcast Acoustical Survey	043302 CC	3.72	33	2004	<Null>
7	Broadcast Acoustical Survey	043303 CC	6.4	33	2004	<Null>
7	Broadcast Acoustical Survey	063312 CC	3.13	33	2006	<Null>
7	Broadcast Acoustical Survey	113319 CC	1.84	33	2011	<Null>
7	Broadcast Acoustical Survey	053805 CC	4.15	38	2005	<Null>
7	Broadcast Acoustical Survey	163806 CC	5.87	38	2016	<Null>
8	No survey if tree removal is trees < 21 in. dbh. and harvesting occurs between 9/1 to 2/28 otherwise Intensive Search Survey	960228 CC	0.53	2	1996	<Null>
8	No survey if tree removal is trees < 21 in. dbh. and harvesting occurs between 9/1 to 2/28 otherwise Intensive Search Survey	880659 CC	2.62	6	1988	<Null>
8	No survey if tree removal is trees < 21 in. dbh. and harvesting occurs between 9/1 to 2/28 otherwise Intensive Search Survey	161904 CC	9.8	19	2016	<Null>

CATEGORY	Type of Survey	HARVEST_ID	ACRES	UNIT	YEAR	AREA_NM
8	No survey if tree removal is trees < 21 in. dbh. and harvesting occurs between 9/1 to 2/28 otherwise Intensive Search Survey	063313 CC	3.57	33	2006	<Null>
8	No survey if tree removal is trees < 21 in. dbh. and harvesting occurs between 9/1 to 2/28 otherwise Intensive Search Survey	073913 CC	6.21	39	2007	<Null>
9	No survey if tree removal is trees < 21 in. dbh. and harvesting occurs between 9/1 to 2/28 otherwise Intensive Search Survey	031707 CC	1.13	17	2003	<Null>
10	Intensive Survey unless removing trees \geq 21 in dbh, then Broadcast Accoustical Survey	020524 CC	7.14	5	2002	<Null>
10	Intensive Survey unless removing trees \geq 21 in dbh, then Broadcast Accoustical Survey	950762 CC	8.65	7	1995	<Null>
10	Intensive Survey unless removing trees \geq 21 in dbh, then Broadcast Accoustical Survey	950763 CC	2.86	7	1995	<Null>
10	Intensive Survey unless removing trees \geq 21 in dbh, then Broadcast Accoustical Survey	880833 CC	4.35	8	1988	<Null>
10	Intensive Survey unless removing trees \geq 21 in dbh, then Broadcast Accoustical Survey	101708 CC	2.83	17	2010	<Null>
10	Intensive Survey unless removing trees \geq 21 in dbh, then Broadcast Accoustical Survey	861901 CC	2.89	19	1986	<Null>
10	Intensive Survey unless removing trees \geq 21 in dbh, then Broadcast Accoustical Survey	861902 CC	1.49	19	1986	<Null>

CATEGORY	Type of Survey	HARVEST_ID	ACRES	UNIT	YEAR	AREA_NM
10	Intensive Survey unless removing trees ≥ 21 in dbh, then Broadcast Accoustical Survey	122501 CC	6.75	25	2012	<Null>
10	Intensive Survey unless removing trees ≥ 21 in dbh, then Broadcast Accoustical Survey	043306 CC	6.2	33	2004	<Null>
10	Intensive Survey unless removing trees ≥ 21 in dbh, then Broadcast Accoustical Survey	063314 CC	3.74	33	2006	<Null>
10	Intensive Survey unless removing trees ≥ 21 in dbh, then Broadcast Accoustical Survey	013704 CC	3.87	37	2001	<Null>
10	Intensive Survey unless removing trees ≥ 21 in dbh, then Broadcast Accoustical Survey	053708 CC	8.96	37	2005	<Null>
10	Intensive Survey unless removing trees ≥ 21 in dbh, then Broadcast Accoustical Survey	133904 CC	3.92	39	2013	<Null>
11	Complete habitat analysis to determine level of survey	820511 CC	20.67	5	1982	<Null>
11	Complete habitat analysis to determine level of survey	020523 CC	22.45	5	2002	<Null>
11	Complete habitat analysis to determine level of survey	870740 CC	11.31	7	1987	<Null>
11	Complete habitat analysis to determine level of survey	000769 CC	10.62	7	2000	<Null>
11	Complete habitat analysis to determine level of survey	031706 CC	10.53	17	2003	<Null>
11	Complete habitat analysis to determine level of survey	952006 CC	11.01	20	1995	<Null>

CATEGORY	Type of Survey	HARVEST_ID	ACRES	UNIT	YEAR	AREA_NM
11	Complete habitat analysis to determine level of survey	932303 CC	11.72	23	1993	<Null>
11	Complete habitat analysis to determine level of survey	862602 CC	22.44	26	1986	<Null>
11	Complete habitat analysis to determine level of survey	082605 CC	10.25	26	2008	<Null>
11	Complete habitat analysis to determine level of survey	043331 CC	26.65	33	2004	<Null>
11	Complete habitat analysis to determine level of survey	093315 CC	42.94	33	2009	<Null>
11	Complete habitat analysis to determine level of survey	883601 CC	18.04	36	1988	<Null>
11	Complete habitat analysis to determine level of survey	163651 CC	49.91	36	2016	<Null>
11	Complete habitat analysis to determine level of survey	163652 CC	45.9	36	2016	<Null>
11	Complete habitat analysis to determine level of survey	013702 CC	32.73	37	2001	<Null>
11	Complete habitat analysis to determine level of survey	023705 CC	41.49	37	2002	<Null>
11	Complete habitat analysis to determine level of survey	043772 CC	56.65	37	2004	<Null>
11	Complete habitat analysis to determine level of survey	133710 CC	20.27	37	2013	<Null>
11	Complete habitat analysis to determine level of survey	143713 CC	15.86	37	2014	<Null>
11	Complete habitat analysis to determine level of survey	143714 CC	51.85	37	2014	<Null>

CATEGORY	Type of Survey	HARVEST_ID	ACRES	UNIT	YEAR	AREA_NM
11	Complete habitat analysis to determine level of survey	143715 CC	28.5	37	2014	<Null>
11	Complete habitat analysis to determine level of survey	163712 CC	31.99	37	2016	<Null>
11	Complete habitat analysis to determine level of survey	073921 CC	37.08	39	2007	<Null>
11	Complete habitat analysis to determine level of survey	073922 CC	64.58	39	2007	<Null>
11	Complete habitat analysis to determine level of survey	163981 CC	22.21	39	2016	<Null>
11	Complete habitat analysis to determine level of survey	163984 CC	52.68	39	2016	<Null>

McCune, Kimberly

Subject: RE: Devils Backbone Patch Cut FPA

From: Amanda Froberg [mailto:afroberg@cowlitzpud.org]

Sent: Friday, November 16, 2018 11:57 AM

To: Emmerson, Kendel <Kendel.Emmerson@pacificorp.com>; Peterman, Summer <Summer.Peterman@pacificorp.com>; McCune, Kimberly <Kimberly.McCune@pacificorp.com>; 'nreynolds@cowlitz.org' <nreynolds@cowlitz.org>; 'ewhite@cowlitz.org' <ewhite@cowlitz.org>; 'brichardson@RMEF.org' <brichardson@RMEF.org>; 'shedhunt@aol.com' <shedhunt@aol.com>; 'Miller, Peggy A (DFW)' <Peggy.Miller@dfw.wa.gov>; 'holmaewh@dfw.wa.gov' <holmaewh@dfw.wa.gov>

Cc: 'jberry@chiltonlogging.com' <jberry@chiltonlogging.com>

Subject: FW: Devils Backbone Patch Cut FPA

Hi All,

Please see below. After more discussions and emails, DNR has granted the Devil's Backbone Patch Cut to be covered under the Alternative Plan. Thanks for the phone discussions I had with many of you after the meeting!

Thank you,

Amanda

Amanda Froberg

Environmental Compliance Manager · Cowlitz PUD

961 12th Avenue · PO Box 3007 · Longview, WA 98632 · BLOCKED@cowlitzpud.org

P: 360.501.9374 · E: afroberg@cowlitzpud.org



From: DNR RE FP PC <pcforestpractices@dnr.wa.gov>

Sent: Thursday, November 15, 2018 2:39 PM

To: Amanda Froberg <afroberg@cowlitzpud.org>

Subject: RE: Devils Backbone Patch Cut FPA

EXTERNAL: Think Before You Click!

Hi Amanda,

I spoke with my District Manager, and we agree that in this specific case an alternate plan could be used to deviate from the reforestation requirement. This is the first time I've seen an alternate plan used in this way, but it seems to allowable within WAC 222-12-040 and 222-12-0401. Please send me the alternate plan forms that reflect 5.8 acres of harvest and we will go ahead and process this application as a Class III (no additional fee required). I will be letting our Forest Practices Division know about this one just in case there is some legal WAC or RCW requirement that I'm not thinking of.

Thank you,

Taylor Mizar

Forest Practices Coordinator

Pacific Cascade Region

Washington Department of Natural Resources (DNR)

Office: 360-575-5039

Mobile: 360-957-8145

taylor.mizar@dnr.wa.govwww.dnr.wa.gov

From: Amanda Froberg <afroberg@cowlitzpud.org>**Sent:** Wednesday, November 14, 2018 4:59 PM**To:** DNR RE FP PC <pcforestpractices@dnr.wa.gov>**Subject:** RE: Devils Backbone Patch Cut FPA

Hi Taylor,

Today was our monthly meeting with the Lewis River Terrestrial Coordinating Committee, members of state and federal agencies responsible for directing the management of wildlife habitat in the Lewis River watershed, members include but are not limited to WDFW, RMEF, USFS, USFWS, NOAA, and Cowlitz Tribe. They direct and approve Cowlitz PUD management of our Wildlife Habitat Management Plan Lands (525 acres). These lands are managed to improve the habitat for wildlife, particularly big game species, over the long-term. They were concerned regarding the conversion issue that we are facing with the 5.8 acre Devil's Backbone Elk Forage Plot and wanted me to ask a few questions:

Is the alternate plan not the mechanism for doing something that isn't traditional forestry, if it is not could you please point us in the right direction to a potential provision?

What is allowed within an alternate plan, are there any changes we need to make to our submitted alternate plan to have our habitat management activity covered?

We are creating the opening for habitat restoration purposes and the 5.8 acres will not be developed. What are DNR's concerns so that we can address and consider a path going forward?

The TCC (WDFW, Cowlitz Tribe and RMEF) is willing to write a letter of support for the project/alternate plan. If that would be helpful please let me know so that I can let them know.

Thank you for your time and assistance,
Amanda

Amanda Froberg

Environmental Compliance Manager · Cowlitz PUD

961 12th Avenue · PO Box 3007 · Longview, WA 98632 · [BLOCKEDcowlitzpud\[.\]orgBLOCKED](mailto:afroberg@cowlitzpud.org)P: 360.501.9374 · E: afroberg@cowlitzpud.org