

Agenda Items

- 9:00 a.m. Welcome,
➤ Review and Accept Agenda
➤ Review and Accept 10/12/2022 Meeting Notes
- 9:10 a.m. Public Comment Period
- 9:15 a.m. Lewis River Wildlife Conservation Plan and proposed correction to September 14, 2022 Meeting notes
- 9:30 a.m. Great Blue Heron nest monitoring and Beaver Bay Campground Construction
- 9:45 a.m. 10.8.4 Habitat Evaluation Procedures Shoreline Sample Size
- 10:00 a.m. Project Updates
➤ Washington State Ebike status
➤ Non-Capacity Amendment to Yale License
➤ Yale Fish Passage
➤ 2023 Meeting Schedule
- 10:30 a.m. Moss Cave Land Acquisition Update (**Confidential**)
- 10:55 a.m. Next Meeting's Agenda
Note: all meeting notes and the meeting schedule can be located at:
<https://www.pacificorp.com/energy/hydro/lewis-river/acc-tcc.html>
- 11:00 a.m. Meeting adjourns

Microsoft Teams meeting

Join on your computer or mobile app

[Click here to join the meeting](#)

Or call in (audio only)

+1 563-275-5003 United States, Davenport Phone Conference ID: 842 906 84#

Meeting Notes
Lewis River License Implementation
Terrestrial Coordination Committee (TCC) Meeting
December 14, 2022
Conference Call

TCC Representatives Present: (6)

Kendel Emmerson, PacifiCorp
 Summer Peterman, PacifiCorp
 Amanda Froberg, Cowlitz PUD
 Peggy Miller, WDFW
 Bill Richardson, Rocky Mountain Elk Foundation

Guests: (1)

Sarah Montgomery, Anchor QEA (note-taker for PacifiCorp)

Calendar:

December 14, 2022	TCC Meeting	Teams Call
-------------------	-------------	------------

Assignments for December 14, 2022	Status
Emmerson: Update the tree tally information and finalize the Saddle Dam Mitigation Memo.	In progress
Emmerson: Send the Moss Cave appraisal to the TCC members by request.	In progress
Peterman: Install game cameras near proposed Saddle Dam (MU10) trail location and report back to TCC on observed trends in game and recreational uses in early 2023.	In progress
Miller and Peterman: Coordinate on WDFW's oak specialist providing feedback on the proposed plantings at Woodland Release Ponds site.	In progress

Assignments for September 14, 2022	Status
All: Review the Draft Lewis River Conservation Plan, and Miller, consider seeking input from WDFW's oak specialist on the plan.	Complete

Assignments for August 10, 2022	Status
Emmerson: Check whether public access will be closed during the Speelyai Park expansion project; consider providing a separate access point to hunters.	Complete. If access is closed, it will only be for a few days.

Assignments for May 11, 2022	Status
Emmerson: Make a tracking sheet for 10.3.3 funding disbursements and include it in the 2022 TCC Annual Report.	In progress

Assignments for April 13, 2022	Status
Emmerson: Consider seeding the timber harvest area in Unit 35 with woody shrubs seed mix for a comparison study.	Complete. Nootka rose and vine maple seed were spread in two of the harvest areas in MU 35

Assignments for December 8, 2021	Status
Emmerson: Discuss potential WHMP disturbance impacts with permitting staff for the Cougar Creek highway project.	In progress (project deferred to 2023)

Assignments for January 13, 2021	Status
Emmerson: Provide a list of past timber harvest areas that have been within the WHMP buffer, associated TCC meeting notes, and reference to the WHMP language.	In Progress

Kendel Emmerson (PacifiCorp) called the meeting to order at 9:01 am. She added an update for the Cougar Creek highway project to the agenda. TCC representatives present revisited the October 12, 2022 discussions on the Saddle Dam (MU10) Trails Conceptual Plan. Overall, the TCC understands the license requirement to build a trail and is providing feedback on the least impactful alternative to wildlife. Summer Peterman volunteered to install game cameras in the proposed trail area to gain a better understanding of game and recreational use. In early 2023, this information can be used to help inform decisions made about the proposed trail location.

Peggy Miller also asked whether there are any long-term concerns for road degradation due to the spring present at the 600C2 culvert site. Emmerson said the engineering team did not have concerns about the stability of the road.

The TCC approved the October 12, 2022 meeting notes.

Public Comment Period

None.

Lewis River Wildlife Conservation Plan

Summer Peterman said she received feedback on the Draft Lewis River Wildlife Conservation Plan during its review period. She shared the comment-response matrix that is being included in the final plan and reviewed each comment. Of note, one comment from WDFW regarded the funding source for the conservation work. Peterman added a table summarizing the funding sources to the plan, none of which are WHMP funds. The funding sources are capital funds in the near-term (like for oak planting and soil work).

She noted some of the comments from John Clapp was in reference to the City of Woodland regarding potential recreational uses of the Woodland Release Ponds property. John suggested considering parking spaces, bicycle use accommodations, and/or walking paths and benches. Peterman reached out to recreational and fisheries staff at PacifiCorp to vet these proposed uses. Their response was the property is not intended for public use and the fish infrastructure presents high , vandalization potential as well as the associated infrastructure presents a high public safety risk (e.g., exposed fish discharge flume and intake vaults). Public parking and increase public use would also create an additional Preventable Vehicle Accident (PVA) potential for the fish trucks so it is not an option to introduce recreational uses to this property.

One final comment from John noted his opposition to encouraging large animal use (like deer or elk) on the property through the restoration work, which could increase the potential for deer/vehicular collisions they noted a preference for encouraging pollinator uses. PacifiCorp's response to this is that the plantings will be focused on providing native plants that are good for birds and pollinator uses.

Peggy Miller noted that she has not yet reached out to WDFW's oak specialist for feedback on the plan but can still do so if desired. Peterman said she would still welcome feedback on the plan, and Miller and Peterman will coordinate on getting this feedback.

Peterman said the final plan will be saved on the Lewis River section of PacifiCorp's website, under "Wildlife, Recreation, and Shoreline Management."

Great Blue Heron Nesting Monitoring and Beaver Bay Campground Construction

Kendel Emmerson shared aerial imagery of the Beaver Bay Campground and described how beavers have changed the hydrology in the area, resulting in flooding of the campground and conversion of parts of the campground and surrounding areas to wetland conditions. PacifiCorp's plan is to move the group camp and replant the existing campground area as a wetland, resulting in a net gain of wetland area. Emmerson said the wetland boundaries were delineated in February 2022, and during that work, potentially nesting great blue herons were observed. Great blue herons are an analysis species for wetlands in the WHMP. The work is planned for the dry part of the summer in 2023, during which grading, excavation, and other construction activities will occur. According to the WHMP, a rookery or colony plan is needed to evaluate and protect the great blue heron nesting area. Emmerson said the plan will include the limited available information, and more data will be collected in spring 2023 to inform the plan and nest locations. Overall, she expects the impacts to the rookery to be minimal because the birds may already be acclimated to disturbance from the campground area, the impacts are only for one season , in the latter part of the nesting season, and the conditions will be restored to better habitat when the project is complete.

Peggy Miller asked if the plan to move the campground triggers a license amendment. Emmerson said no. Miller asked whether the TCC has provided review or comments on this action. Emmerson said campgrounds are secondary WHMP areas, so the TCC does not generally provide much input on actions to secondary areas. She noted that the new campground's design will help keep people more contained to the areas where disturbance should occur, and the design and construction have been approached in a way that is responsible to WHMP lands (e.g., not clear-cutting). Summer Peterman noted the new campground will have a smaller footprint, so there is a net gain of wetlands that are higher quality. She noted she helped other PacifiCorp staff with an

initial consultation of how to approach the issue, though there has been turnover in staff that has made the permitting and internal coordination processes more disjointed than usual. She said the flooding and road degradation have been recent triggers to push this project along.

10.8.4 Habitat Evaluation Procedures (HEP) Shoreline Sample Size

Emmerson shared an update on the HEP process. She said she is still working on the elk model, which she will discuss with the TCC in 2023. She has recently made progress on determining the sample sizes for shoreline areas and shared a spreadsheet showing the calculations. For the new HEP, line-intercept transects of 100 meters will be conducted in areas classified as “lake and riverine shorelines.” She reviewed the percentages of lake and riverine shoreline types in different areas of the WHMP and showed how the sample transects are distributed amongst the habitat types and areas, including riverine unconsolidated bottom, which is a new habitat type. Overall, there are 427 lake and riverine shoreline transects planned for the new HEP. Miller confirmed that the number of surveys in each of the category types match up to the percentages of habitat of each type.

The next steps for the HEP are to continue working on the elk model and bring a consultant on board. Models that are desktop exercises like the elk model could feasibly start any time.

Project Updates

Washington State E-Bike Regulations

Summer Peterman provided a review of the Washington Department of Natural Resources and WDFW’s recent report, “E-Bike Use on DNR- and WDFW-managed Lands: A Report to the Legislature in Response to ESSB 5452” (WDFW and DNR, 2022). The report is available for download from the DNR or WDFW websites. Peterman summarized the scope and results of the report. Its purpose is to provide a recommendation to the legislature on how to manage e-bike use on state-managed lands. The research engaged federally recognized tribes, the public, and various organizations through surveys, town halls, and focus groups. Peterman said the results of the report or the general feedback from different stakeholders was not surprising. She said the final recommendation from WDFW and DNR is for each agency to manage access needs based on the intended management purposes of the area. For example, an area that’s main purpose is to be managed for wildlife might have stricter use criteria than one managed for recreation. One interesting aspect of the guidance is that all classes of e-bikes should be considered in areas where e-bikes are allowed and should be considered distinct from other motorized users (e-bikes, motorized vehicles, and mountain bikes should all be their own use type). This results in new signage needs, and until that use category can be communicated, all trails closed to motorized use are closed to e-bikes unless otherwise stated. Notably, trail users with an ADA card can use an e-bike without restriction on WDFW and DNR-managed lands.

Peterman asked the TCC whether the regulations for e-bike use on WHMP lands should change given this new guidance from WDFW and DNR. Peterman noted that WHMP lands do not have the same ADA requirements (reasonable accommodation) as state-managed lands. TCC representatives present discussed potential e-bike use of WHMP lands and potential ADA stipulations.

The TCC representatives present confirmed there are no changes to e-bike regulations on WHMP lands.

The TCC will continue to re-evaluate recreational use of WHMP lands as new information becomes available.

Cougar Creek Culvert Project

Emmerson shared photos of the Cougar Creek culvert. There was an online meeting between WSDOT and interested parties, including the Yakama Nation and WDFW, regarding Cougar Creek this week. Emmerson reviewed the scour issues that could potentially wash out the highway, and the proposed action of excavating gravel and moving it to the opposite bank. WSDOT is working on permits for the project as soon as possible. Because part of the project occurs on WHMP lands, PacifiCorp is discussing mitigation for the impacts with WSDOT. WSDOT is unable to pay compensatory mitigation, so in-kind mitigation is more likely. Options being considered include removing invasive species and replanting adjacent to the site. The Yakama Nation is advocating for the addition of wood upstream of the culvert. This option has not been ruled out but might be a Phase 2 action because of the urgency in addressing the scour issue and longer design timeline for adding woody material. When Emmerson has more information from WSDOT regarding impacts to WHMP lands, she will discuss the mitigation options with the TCC. There is also a project summary that Emmerson will provide to the TCC. Peggy Miller noted she is concerned about the impacts to aquatic habitat and bull trout and suggested that WSDOT engage early with USFWS to discuss potential effects. Emmerson said she has provided the project information to Erik Lesko at PacifiCorp (for consideration with the ACC). Emmerson noted the in-water work window for the Lewis River overlaps with bull trout presence in Cougar Creek, so the work is proposed in June when bull trout presence is unlikely. Jeremiah Doyle (PacifiCorp) is also providing input on potential bull trout effects due to his knowledge of and work in Cougar Creek.

Non-Capacity Amendment to Yale License

Emmerson said FERC is requiring a license amendment for the Saddle Dam remediation work. PacifiCorp drafted the amendment, which is currently available for a 90-day review by the TCC. She offered to answer any questions about wildlife impacts that might arise during the review period. She reminded the TCC that mitigation for impacts to WHMP lands has been evaluated by the TCC but was not finalized because the tree removal had not been finalized. A draft memo describing this mitigation needs to be prepared and finalized in early 2023 now that the final numbers of trees removed can be tallied. Miller said WDFW is reviewing the amendment, with a focus on fish and wildlife impacts, and will include a comment indicating the expected mitigation.

Yale Fish Passage

Emmerson provided an update on fish passage at Yale Dam. She said the design team is presenting 30% designs at a meeting this afternoon. She discussed potential WHMP impacts with the design team previously, at which point there were no anticipated WHMP impacts. She noted that the TCC should continue to monitor the design progression to identify and evaluate potential WHMP impacts as needed. Peggy Miller said one concern is that roads may need to be built through WHMP lands to provide access to the fish passage facilities.

Moss Cave Acquisition – Due to confidential information details of this portion of the meeting have been omitted from these meeting notes.

Emmerson reviewed the appraisal for the Moss Cave property. The TCC reviewed a map of the Moss Cave property and surrounding area and discussed the various potential access routes, old roads, and property owners, including an area where Cowlitz PUD owns a rough road that could be used to approach the Moss Cave area, though access would still be needed through DNR.

Administrative

Emmerson asked the TCC if the meeting calendar for 2023 should continue being held on the second Wednesday of each month. TCC representatives confirmed that either 9:00 or 9:30 works as a start time, and many of the meetings in 2023 are expected to be virtual.

Agenda items for February 8, 2023

- Review December 14, 2022, Meeting Notes
- WHMP Annual Report - Draft
- 2023 Budget
- Saddle Dam Mitigation Memo – review in January, plan to finalize in February
- Game Camera Update from Saddle Dam MU10 Area
- Study/Work Product Updates

Next Scheduled Meeting

February 8, 2023
Merwin Hydro Control/Teams

Attachments:

- December 14, 2022, Meeting Agenda
- Cougar Creek Power Point
- Moss Cave Appraisal upon request
- MU 26 (Moss Cave) map
- Great Blue Heron Nest Map
- *[See HEP Materials on PacifiCorp website]*

Adjourn Meeting 10:32 a.m.













Conceptual Recommended action

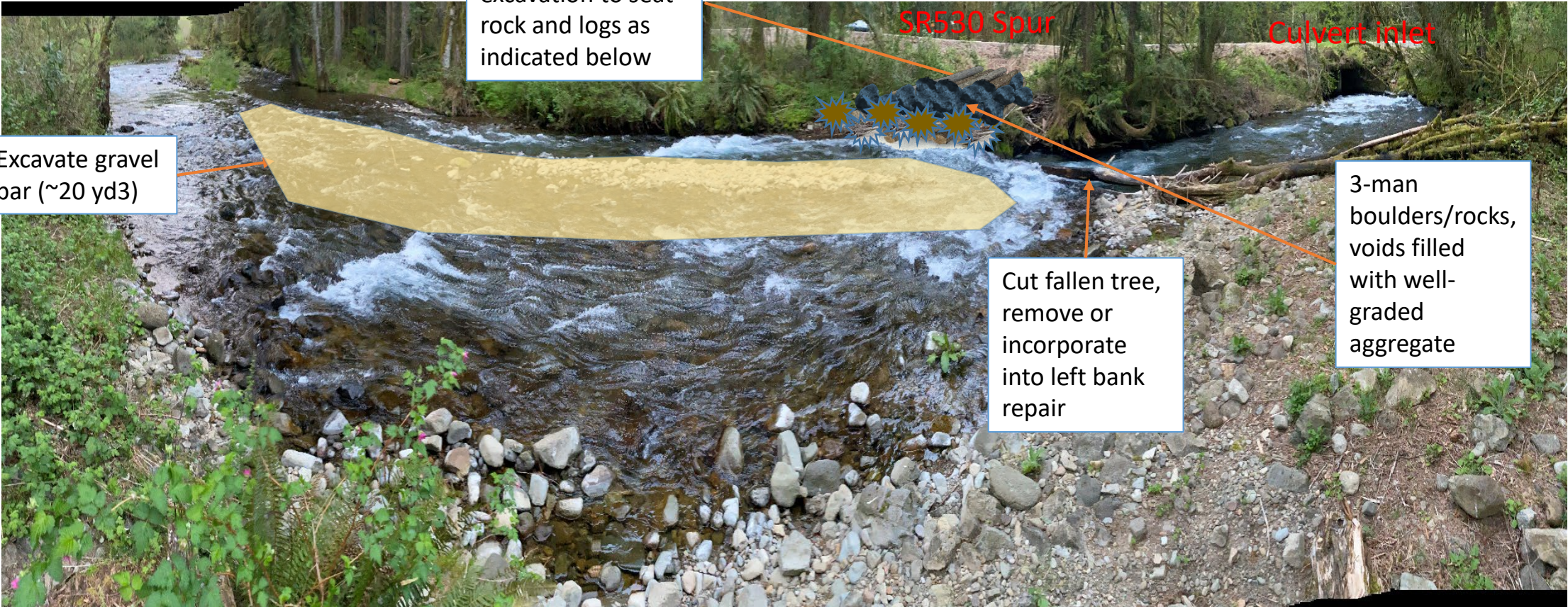

Cross-section of site (looking upstream)

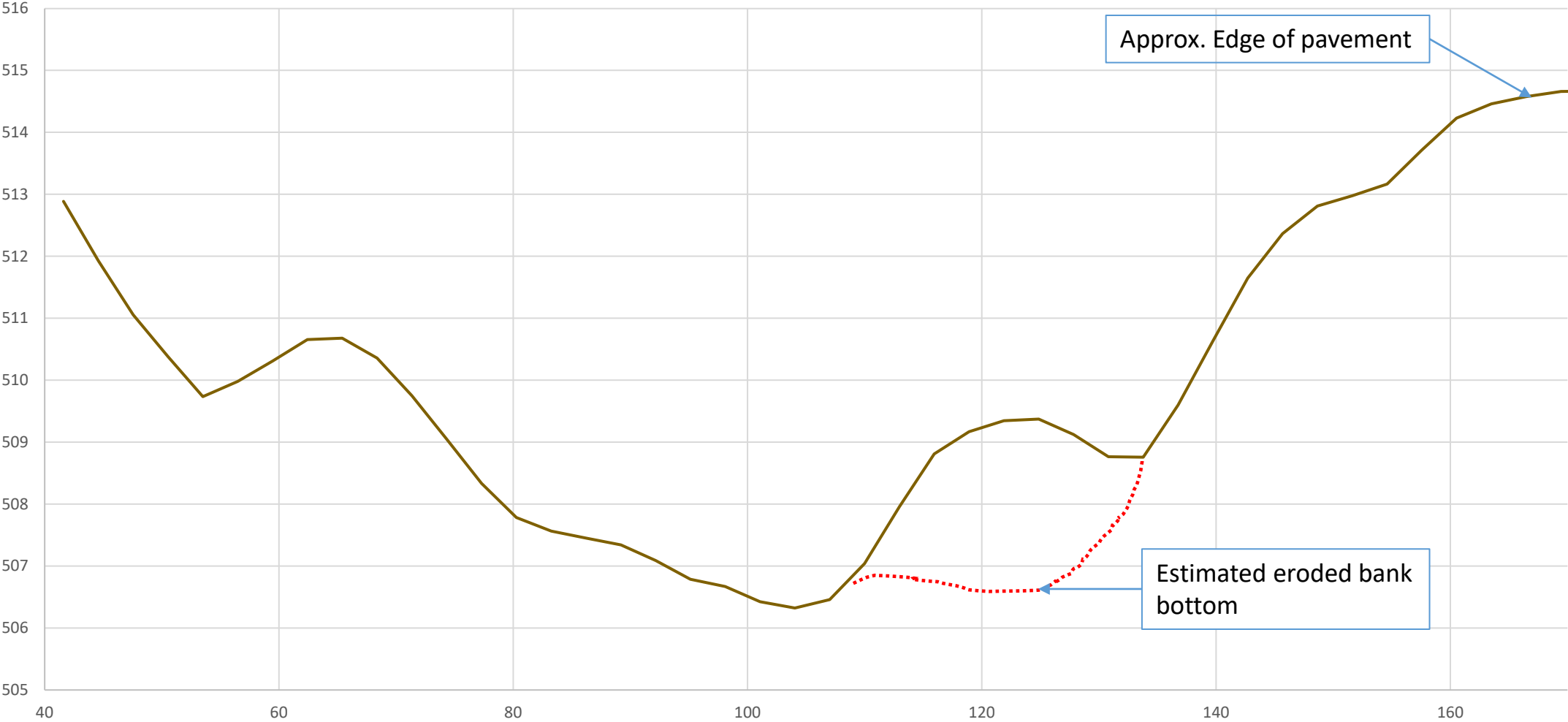

Cross-section profile taken from 2019 LiDAR

Cross-section of recommended stabilization

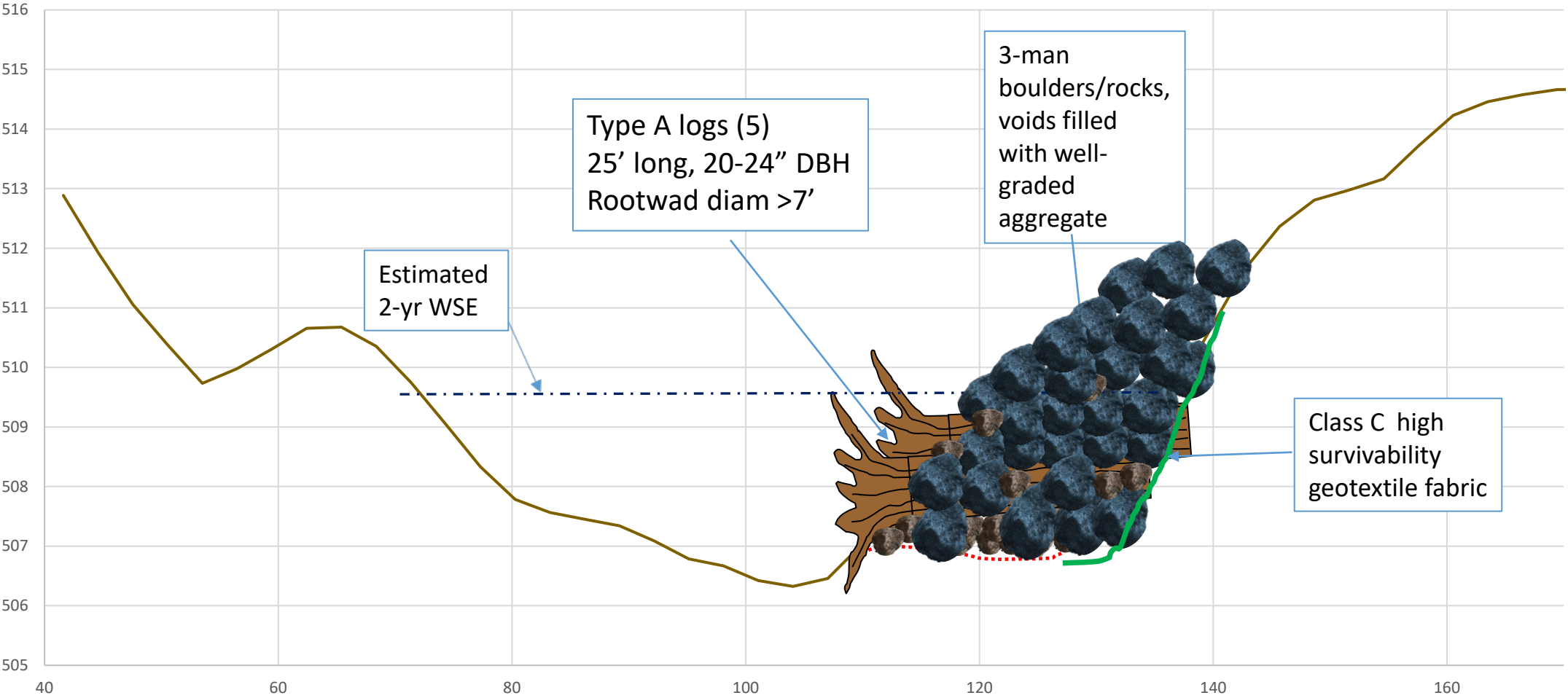

Cross-section profile taken from 2019 LiDAR

Cross-section of recommended stabilization

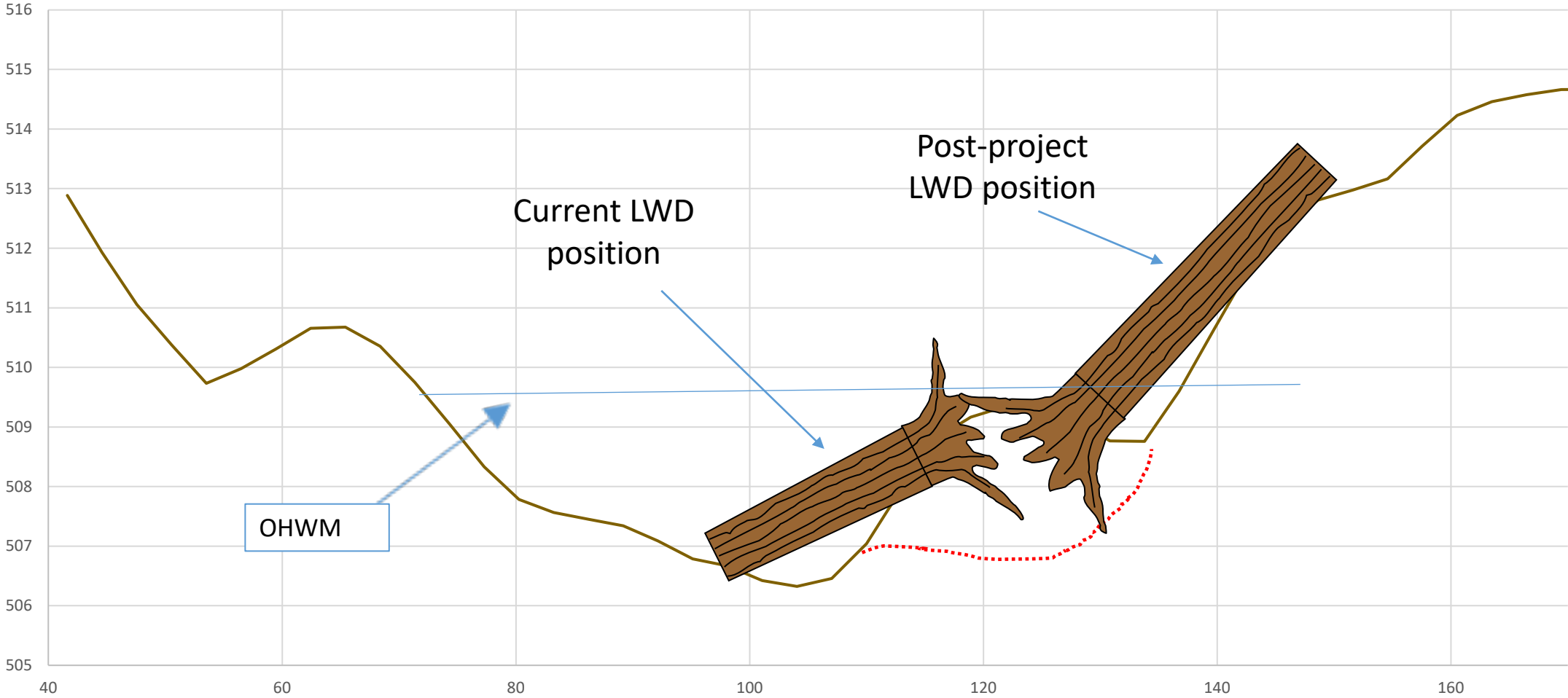



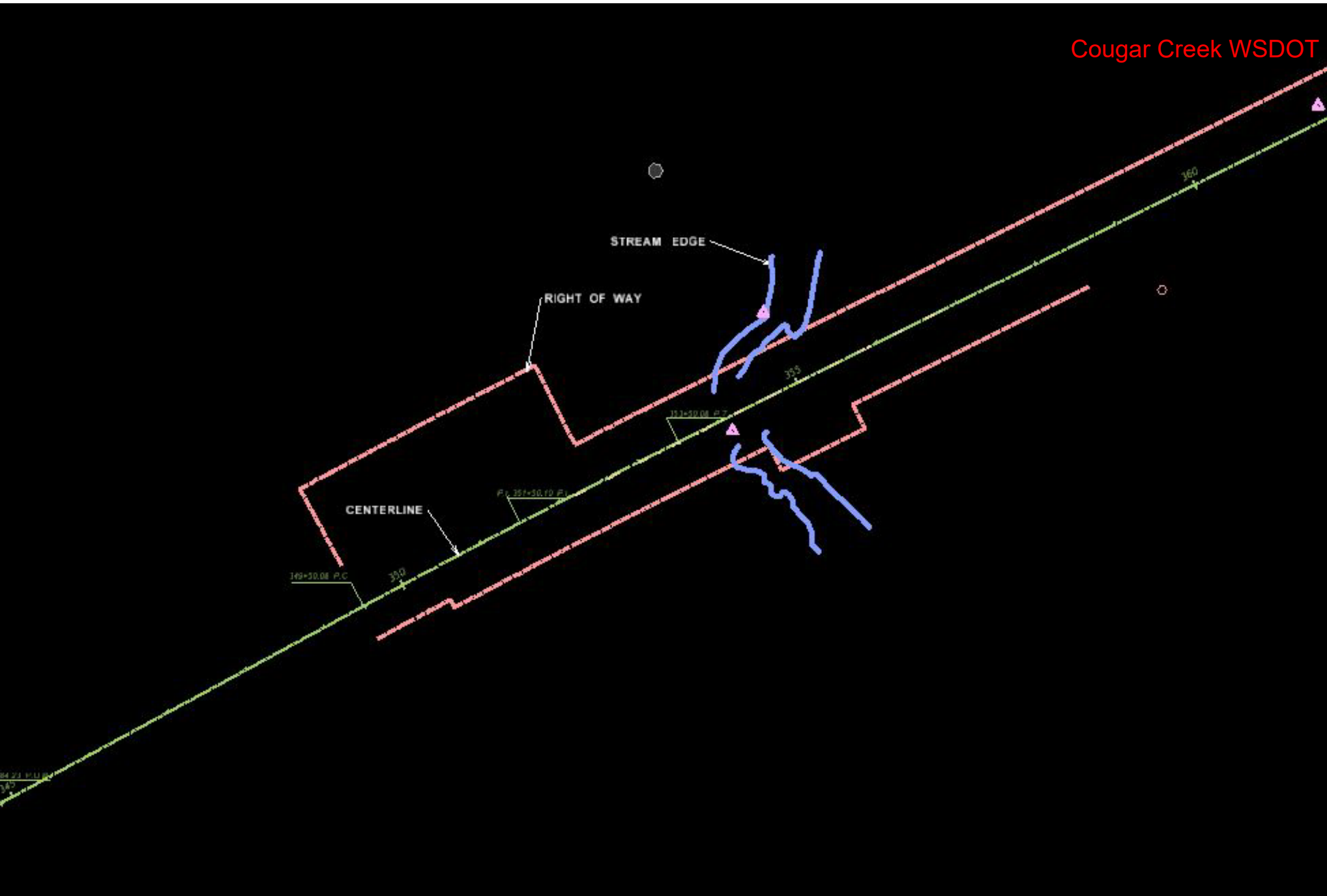















Cross-section profile taken from 2019 LiDAR



Lewis River

Unit 26 Access

- | | | | |
|---|---|--|--|
|  Management Unit |  County Tax Lot |  Fish Stream |  Road Block |
|  Highlighted Route |  County Boundary |  Non-fish Perennial |  Gate |
|  Easement Rights (The Nature Conservancy) |  Transmission Line |  Non-fish Seasonal |  Contour (40ft) |
|  Easement Rights (The Nature Conservancy and Chilton Logging) |  Highway |  Other Stream | |
| |  Road |  Water Body | |
| |  Abandon/Orphan Road |  Wetland, Pond | |



Data are projected in UTM Zone 10, NAD83, meters.

PacificCorp makes no representations or warranties as to the accuracy, completeness or fitness for a particular purpose with respect to the information contained in this map. PacificCorp shall have no responsibility or liability to any person or entity resulting from the use of any information furnished in this map.

12/13/2022 U:\Projects\2022\22-483\Unit 26 Access.mxd

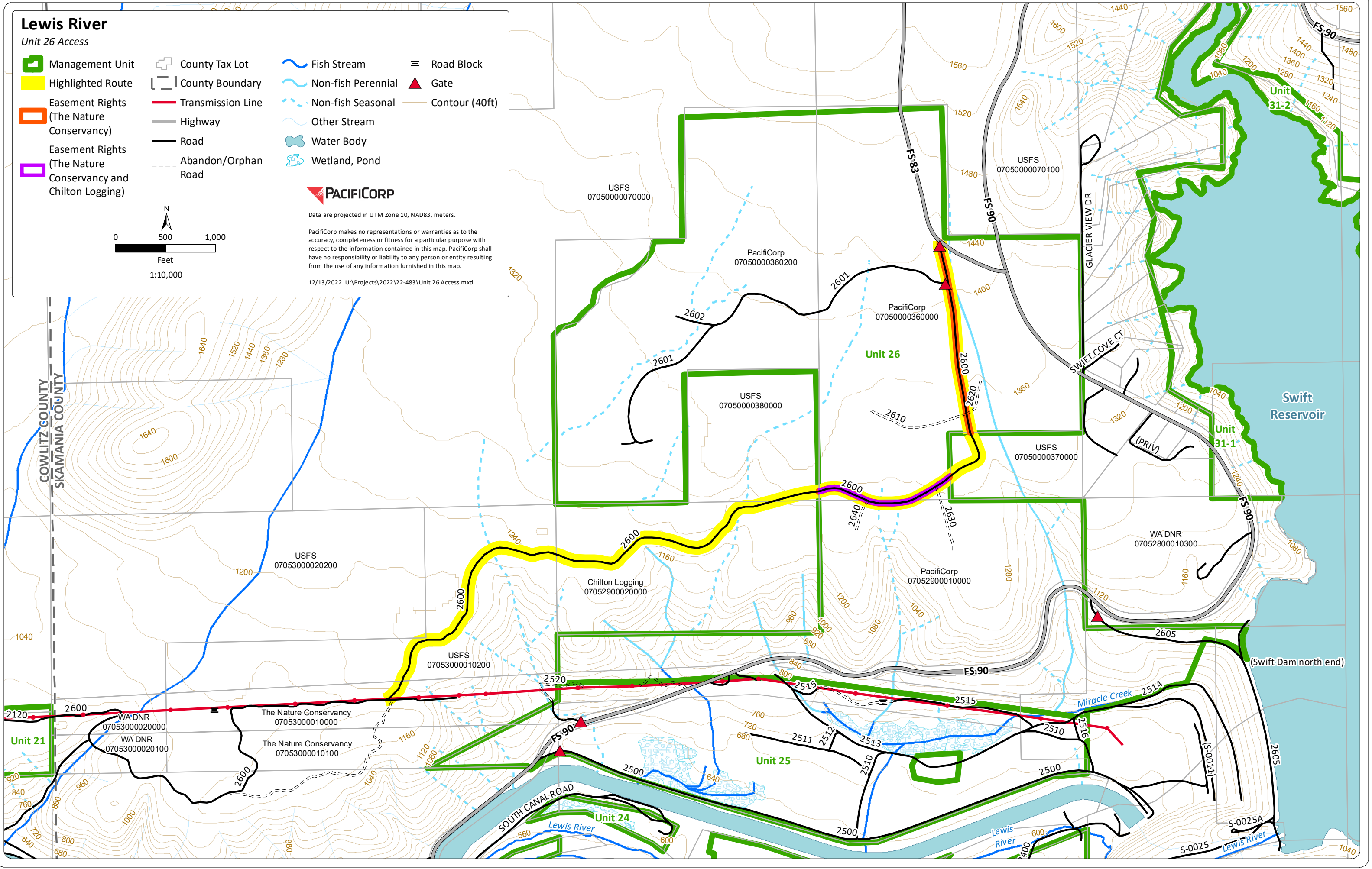
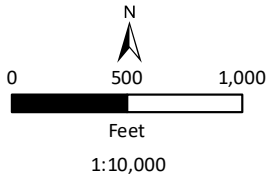

Great Blue Heron
Nest at Beaver Bay

Great Blue Heron nests

Beaver Bay Park